

COMMERCIAL SPACE FOR LEASE Concord, CA

Public
Storage



LOCATION: 2350 Monument Blvd
Concord, CA

SIZE: 4600 SF.

AVAILABILITY: No Availability

AMENITIES: Strong Demographics Concrete Block Construction
Easy access High Traffic Location
Abundance of Parking Developed Area, Costco adjacent

For more information on this opportunity, please contact:

Public Storage
Real Estate Division

Kari Kramer
Commercial Leasing Manager
(747)258-4523 Office

www.pscommercialrealestate.com

kkramer@publicstorage.com

This flyer is intended only as preliminary information on space available for lease; the property owner and its representatives make no representation that it is accurate or complete. Prospective tenants are advised to conduct their own investigation of the suitability of the premises for their intended use, and to consult with legal and tax professionals regarding the consequences of entering into a lease. All terms are subject to change and all spaces are subject to prior rental or withdrawal from the market without notice.

Site Plan

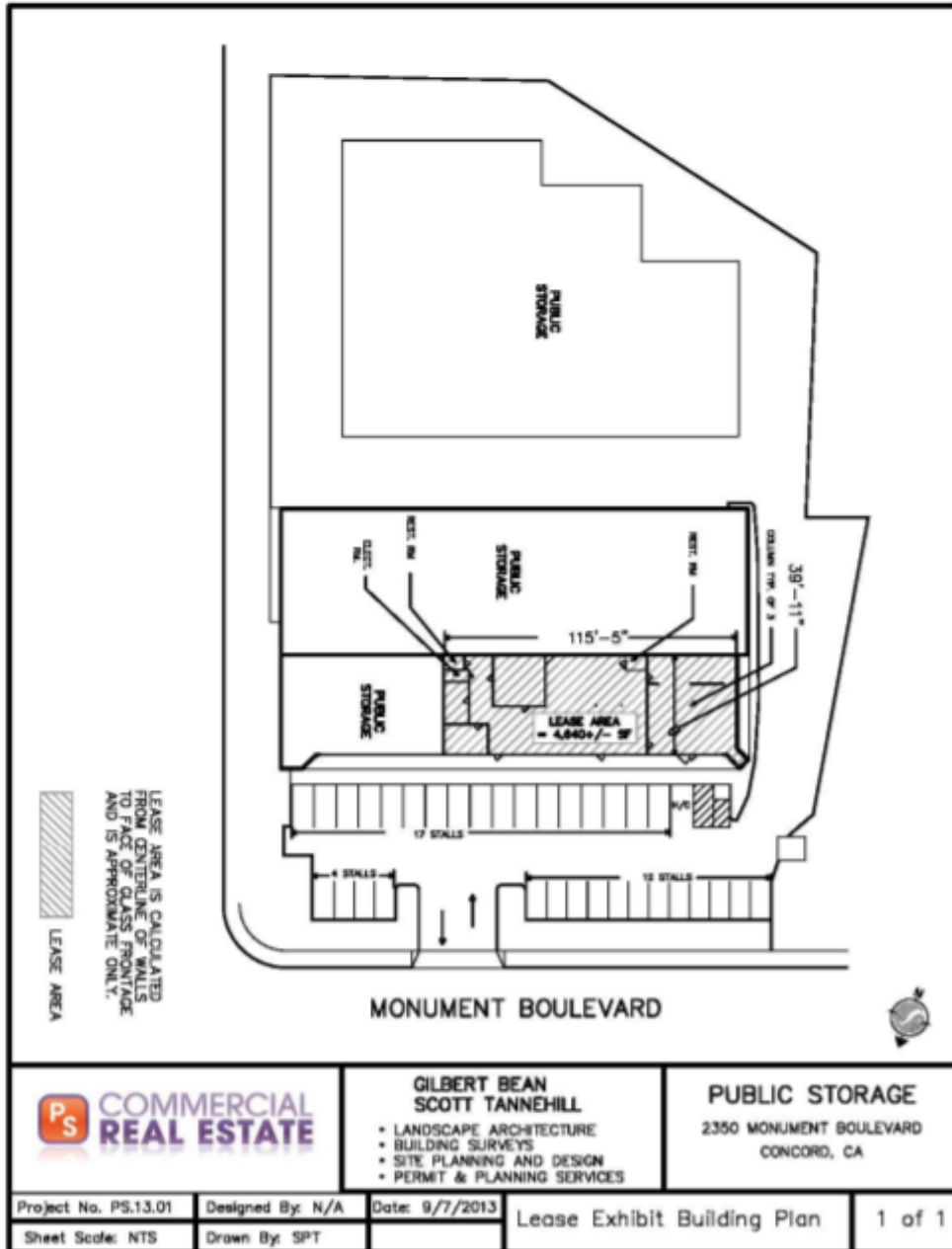

COMMERCIAL SPACE FOR LEASE

Concord, CA

